

### TECHNICAL CHARACTERISTICS OF THE CERAMIC DISCS:

Material:	<b>AL<sub>2</sub>O<sub>3</sub></b>
Surface roughness Ra:	<b>0.2 μm</b>
Contact surface area:	<b>50-80%</b>

### TECHNICAL CHARACTERISTICS OF THE CARTRIDGE:

Opening angle:	<b>25°</b>
Max mixing angle:	<b>90°</b>
Max temperature:	<b>90°C/194°F</b>

Recommended tightening torque:

**12-13 Nm / 106-115 lbf\*in**

Pressure test:

Pneumatic:	<b>6 bar / 87 psi</b>
Hydraulic:	<b>35 bar / 500 psi</b>

Flow rate:

(3 bar / 45 psi, test faucet, EN 817)

**22 l/min / 5.8 gpm with resistance „C”**

**35 l/min / 9.2 gpm without resistance**

Endurance test:

EN 817	70 000 cycles
ASME A 112.18.1M	500 000 cycles

- Hot/cold inlet connections must be reversed.
- Interchangeable with conventional K-35 models except for the handle.
- Ideal for new handle designs.

### FLOW RATE CURVES

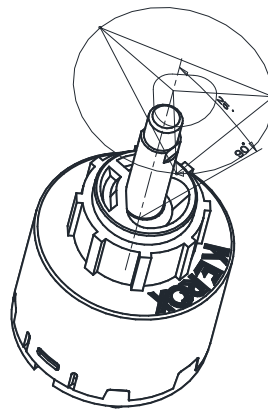
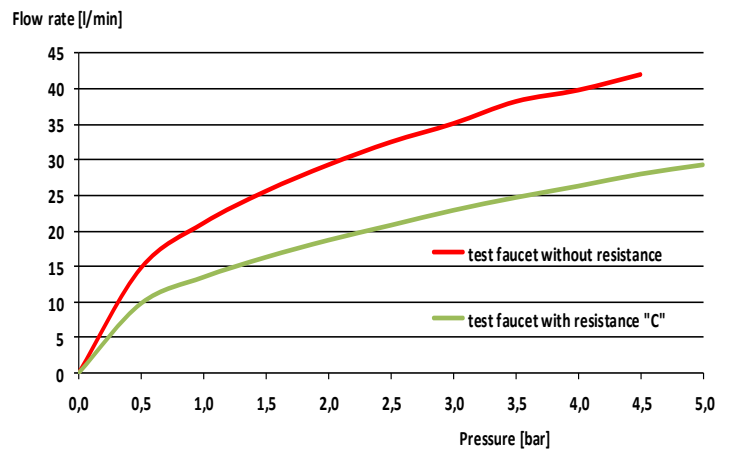

### LEVER MOVEMENT RANGE

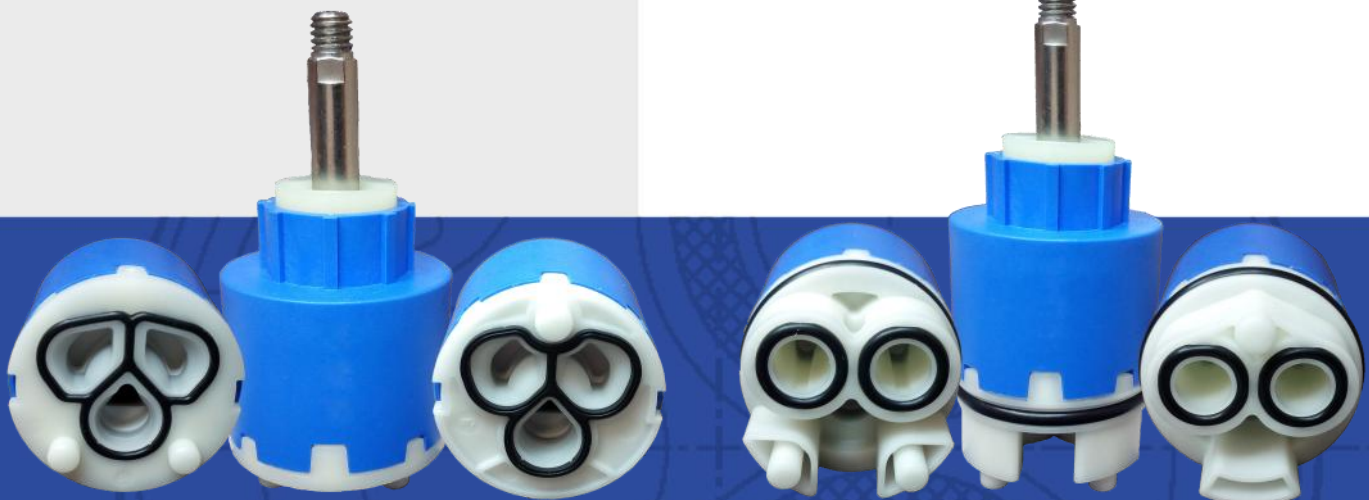

# KJ-35

## CARTRIDGES

A • B • C • D

### Cartridges

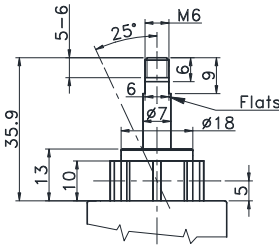
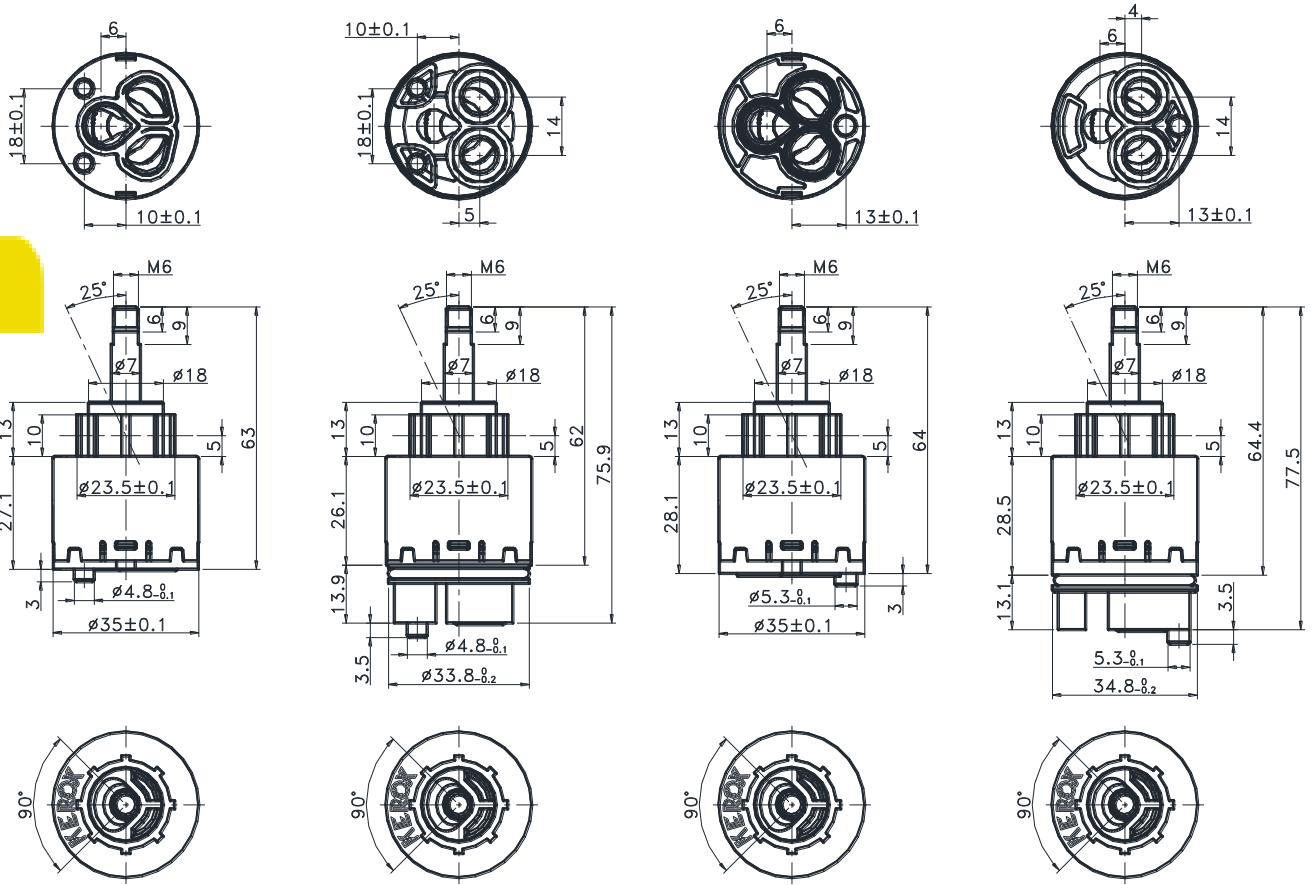

### Bodies

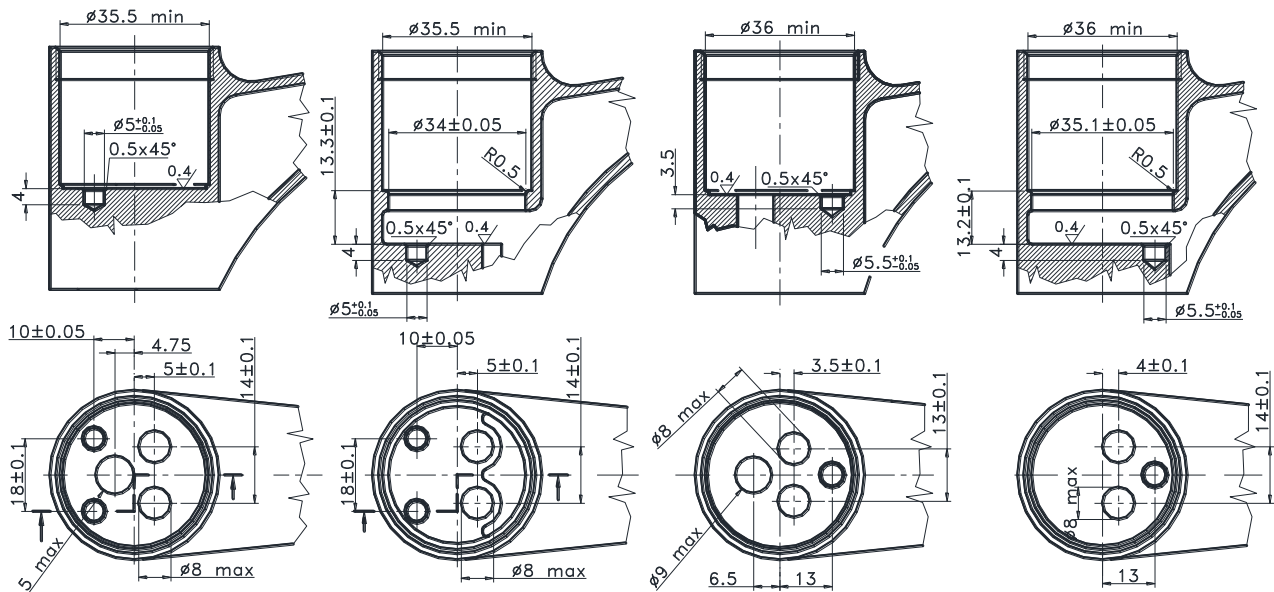

KJ - 35 A

KJ - 35 B

KJ - 35 C

KJ - 35 D